

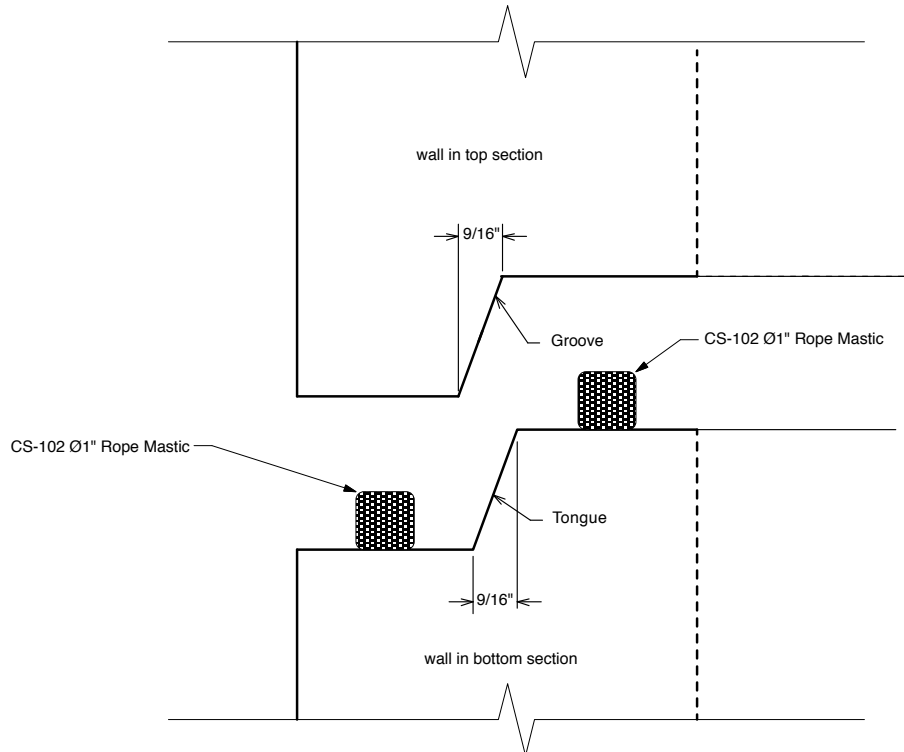

Advance Concrete Product Co.
975 N. Milford Rd. • Highland, MI
(248)887-4173 • (800)824-8351
FAX (248)887-2755



Lap-Joint Detail



For the tank components to fit together correctly and the butyl rope mastic to function properly, the following items must be addressed by the contractor...

- The bottom of the excavation should be level, MDOT Class 2 backfill, compacted to 95% max. density.
- The sidewalls be backfilled in 12" to 24" lifts with MDOT Class 2 backfill, compacted to 95% max. density.